



D5 5TH FLOOR CONSTRUCTION PLAN
SCALE: 1/8" = 1'-0"

- SHEET NOTES (XX)**
- 01 ALIGN CENTER OF PARTITION WITH CENTER OF EXISTING EXTERIOR GLAZING VERTICAL MULLION. TYPICAL FOR ALL LOCATIONS.
 - 02 EXTEND PARTITION TO EXISTING EXTERIOR GLAZING VERTICAL MULLION. PROVIDE ACOUSTICAL FILL BETWEEN VERTICAL MULLION AND PARTITION END. TYPICAL FOR ALL LOCATIONS.
 - 03 CENTER THE SCHEDULED PARTITION AT THE COLUMN LINE. TYPICAL.
 - 04 GLASS PARTITION IS CENTERED AT CENTER OF ADJACENT REGULAR PARTITION.
 - 05 ALIGN INSIDE FACE OF EXTERIOR MULLION WITH INSIDE FACE OF OFFICE DEMONTABLE PARTITION FRAME. PROVIDE FILLER PANEL BETWEEN EXTERIOR WALL AND INTERIOR PARTITION.
 - 06 PROVIDE EQUALLY SPACED ON CENTER - MBG11A - 238" METAL BRUSH DESK GROMMETS. COORDINATE WITH POWER AND DATA OUTLET LOCATIONS.
 - 07 PROVIDE LAYER OF GYP BOARD AND SOUND INSULATION AT EXISTING WALLS IF THEY ARE NOT FINISHED.
 - 08 PROVIDE SCHEDULED PARTITION OR MATCH EXISTING PARTITION TYPE WITH SOUND INSULATION IN WALL CAVITY.

- GENERAL NOTES**
- 1 DIMENSIONS: DO NOT SCALE DRAWINGS. WRITTEN DIMENSIONS GOVERN. ALL PARTITION LOCATIONS SHALL BE AS SHOWN ON PARTITION PLAN. IN CASE OF CONFLICT, NOTIFY ARCHITECT. PARTITION PLAN BY ARCHITECT TAKES PRECEDENCE OVER ALL OTHER PLANS.
 - 2 PARTITIONS: ALL GYPSUM BOARD PARTITIONS SHALL BE TIED AND SANDED SMOOTH WITH NO VISIBLE JOINTS OR LINES. ALL SCREWS OR OTHER ATTACHMENT DEVICES SHALL BE PATCHED AND NOT VISIBLE. PATCH AND REPAIR SURFACES TO MATCH ADJACENT OR ADJOINING SURFACES WHERE REQUIRED. ALL SURFACES SHALL BE ALLOWED AND SANDED SMOOTH.
 - 3 DIMENSION REFERENCE POINTS: ALL PARTITIONS ARE DIMENSIONED FROM FINISH FACE OF GYPSUM BOARD TO FINISH FACE OF GYPSUM BOARD, UNLESS NOTED OTHERWISE. ALL DIMENSIONS TO THE EXTERIOR WINDOW WALL ARE TO THE INSIDE FACE OF SILL, UNLESS NOTED OTHERWISE.
 - 4 CLEAR DIMENSIONS: DIMENSIONS NOTED "CLEAR" OR "CLR" MUST BE ACCURATELY MAINTAINED, AND SHALL NOT VARY MORE THAN ± 1/8" WITHOUT WRITTEN INSTRUCTION FROM ARCHITECT.
 - 5 DIMENSION TOLERANCES: DIMENSION TOLERANCES SHALL BE WITHIN CODE DEFINED CRITERIA OF AUTHORITY(IES) HAVING JURISDICTION. VERIFY FIELD DIMENSIONS NOT WITHIN TOLERANCES WITH THE ARCHITECT AND SECURE ARCHITECT'S APPROVAL. DISCREPANCIES NOTIFY ARCHITECT IN WRITING OF ANY DISCREPANCIES OR CONFLICTS IN THE LOCATION(S) OF NEW CONSTRUCTION. VERIFICATION OF THE PARTITION LAYOUT TO BE PROVIDED BY THE ARCHITECT PRIOR TO PARTITION INSTALLATION.
 - 6 EXPOSED EDGES: ALL EXPOSED GYPSUM BOARD EDGES TO HAVE METAL EDGE TRIM.
 - 7 ALLOWMENT: ALL WORK SHALL BE CREATED AND INSTALLED PLUMB, LEVEL, SQUARE AND TRUE, AND IN PROPER ALIGNMENT. "ALIGN" MEANS TO ACCURATELY LOCATE FINISHED FACES IN THE SAME PLANE.
 - 8 MULLIONS: REFER TO MILLWORK SHOP DRAWINGS FOR SPECIFIC DETAILS OF COORDINATION BETWEEN DRYWALL/MILLWORK LOCATIONS.
 - 9 CEILING HEIGHT PARTITIONS: REFER TO REFLECTED CEILING PLANS FOR SOFFITS, CEILING HEIGHTS, AND PLENUM BARRIER LOCATIONS.
 - 10 NOTES AND REFERENCES: REFER TO SHEET A00.100 FOR ADDITIONAL NOTES, LEGENDS, SYMBOLS, ABBREVIATIONS, AND SCHEDULES.
 - 11 ARCHITECT APPROVAL: OBTAIN APPROVAL FROM ARCHITECT PRIOR TO MODIFYING COLUMN FURNISH, RELOCATING PIPES, AND SIMILAR SYSTEMS AND TIE-INS, ADJUSTING ANY AND ALL OTHER FIELD CONDITIONS NOT SHOWN IN PLANS AND REQUIRED TO FIT PLANS.
 - 12 SLAB WORK: ALL EXISTING AND NEW FLOOR SLAB PENETRATIONS FOR PIPING SHALL BE FULLY PACKED AND SEALED IN ACCORDANCE WITH THE APPLICABLE BUILDING AND FIRE CODES.
 - 13 DOOR CLEARANCES: FROM THE BOTTOMS OF DOORS TO CLEAR THE TOP OF FINISHED FLOOR, AS APPLICABLE, BY 5/8" MINIMUM, UNLESS NOTED OTHERWISE. VERIFY CLEAR CONDITIONS AND TRIM EACH DOOR TO FIT CONDITIONS WHERE RADICAL VARIATIONS IN FLOOR ELEVATION EXIST. DOORS SHALL BE ORDERED WITH BOTTOM STILE SIZED TO ACCOMMODATE THESE UNDERCUT CONDITIONS.
 - 14 GLASS WORK: ALL GLASS SHALL BE CLEAR TINTED GLASS, UNLESS NOTED OTHERWISE. GLAZING TONG MARKS SHALL NOT BE VISIBLE. CLEAN AND POLISH ALL GLASS PRIOR TO PROJECT CLOSE-OUT.
 - 15 CEILING HEIGHT PARTITIONS: CEILING HEIGHT PARTITIONS SHALL BE INSTALLED TIGHT TO FINISHED CEILING, WITH NO JOINTS VARYING MORE THAN 1/8" OVER 4'-0".
 - 17 DOOR DIMENSIONS: DIMENSIONS LOCATING DOORS ARE TO THE INSIDE EDGE OF JAMB, UNLESS NOTED OTHERWISE. ALL DOORS SHALL HAVE 1/8" CLEAR ON STRIKE/SILL SIDE OF DOOR. VERIFY AND ADVISE ARCHITECT OF EXCEPTIONS PRIOR TO CLOSING OUT PARTITION LAYOUT.
 - 18 MILLWORK: ALL MILLWORK TO BE FASTENED TO THE PARTITION. PROVIDE BACKING FOR ALL MILLWORK NOT SUPPORTED ON THE FLOOR AND ALL MILLWORK INSTALLED AT 48" AFF OR GREATER.
 - 19 CONTRACTOR TO PROVIDE SHOP DRAWINGS FOR MILLWORK, DOORS/FRAMES/HARDWARE, GLAZING AND GLAZING FRAMING, CARPET SEAMING DIAGRAM (IF APPLICABLE), DEMOUNTABLE PARTITIONS.
 - 20 ALL EXISTING WALLS WERE CONSTRUCTED WITH OTHER PERMITS AND OR CONTRACTS. CONTRACTOR TO FIELD VERIFY CONSTRUCTION AND WIDTH PRIOR TO FABRICATION OF DOOR FRAMES OR COMPONENTS WHICH REQUIRE THE WIDTH OF THE WALL TO BE SET.
 - 21 ALL NEW INTERIOR DOORS FRAMES SHALL BE FACTORY FINISHED, UNO. ALL EXISTING DOORS FRAMES SHALL BE REFINISHED AS REQUIRED TO BE IN LIKE NEW CONDITION, AND PER FINISH PLAN FINISH SCHEDULE.
 - 22 ALL CONCEALED BLOCKING AND LUMBER IS TO BE FIRE TREATED FOR TYPE I, AND TYPE II CONSTRUCTION.
 - 23 CEILING/TONG BACKER BOARD (HARDBACKER BOARD) OR APPROVED EQUAL, AT PARTITIONS SCHEDULED TO RECEIVE TILE FINISH, UNO.

Nuveen
601 Massachusetts Ave, NW
Washington, DC, 20001

GPI - M.E.P Engineer
530 Gaither Road, Suite 100,
Rockville, MD 20850

ALLIANCE LIGHTING
9125 Guilford Road, Suite 100
Columbia, MD 21046

25 Massachusetts Ave.

5th level - Suites G,H,I & J

ISSUE FOR CONSTRUCTION & PERMIT

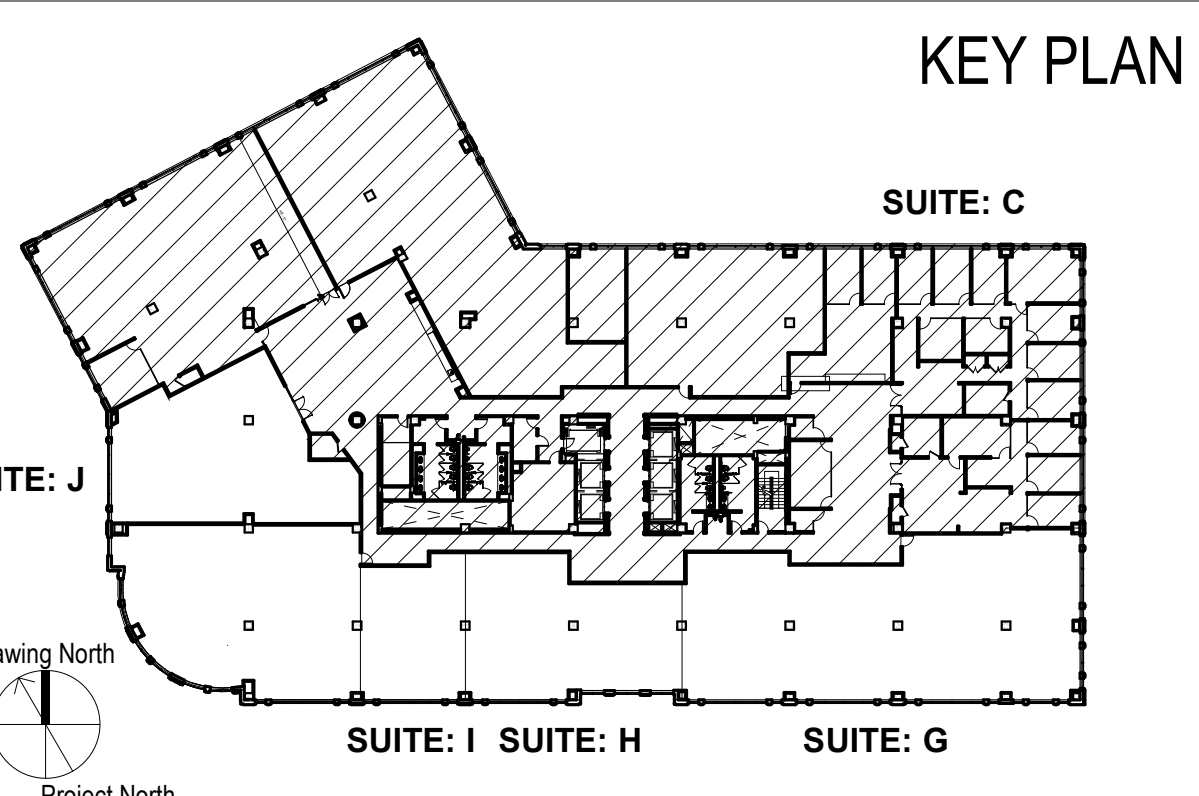

NO.	DATE	REVISIONS
5	11/18/2020	ISSUE FOR CONSTRUCTION & PERMIT

MKDA
MILO KLEINBERG
DESIGN ASSOCIATES, INC.
2000 M ST, NW, SUITE 750 MKDA WASHINGTON DC, 20036

ARCHITECT OF RECORD:

PROJECT
25 MASSACHUSETTS AVENUE - FIFTH LEVEL

25 Massachusetts Ave NW,
Washington, DC 20001

DRAWING TITLE
CONSTRUCTION FLOOR PLAN

SEAL & SIGNATURE 	DATE 11/13/2020
PROJECT NUMBER Working DWG. BY	Project Number
DRAWING No.	IN101

These plans are the sole property of MKDA DESIGN ASSOCIATES, INC. 2020 MKDA, INC. ©
Use without permission is strictly prohibited and will result in the violation of legal consequences.